



Caution

The information available from this website, which is checked and updated annually, has been prepared from industry sources for use by the professional automotive technician engaged in daily vehicle service and repair operations. Detailed knowledge of a particular engine is not required to make full use of this information.

It has been written and presented in a way that enables any professional automotive technician with an appropriate level of skill and competence to carry out the work required. The information applies only to standard models and does not apply to vehicles fitted with equipment other than the standard production options.

The source material used for compilation has been obtained from the vehicle manufacturers and was believed to be the latest available at the time of compilation.

Manufacturers' information is liable to change at any time and there may have been updates or revisions which applied to this information but were not available at the time of compilation. Later material published by the manufacturers may also contain revisions which would be applicable retrospectively to this information and which, accordingly, will not be reflected in this compilation.

Timing Chains & Gears

Timing chains and gears, unlike timing belts, do not require routine replacement. However they may have to be removed or replaced in the course of other repair work or at very high mileage. It is important to follow the general precautions and the specific valve timing instructions for each engine.

DISCLAIMER OF WARRANTIES: Although this information has been obtained from sources generally thought to be reliable, no warranty (expressed or implied) can be made as to its accuracy or completeness, nor is any responsibility assumed by Autodata Limited or anyone connected with it for loss or damages suffered through reliance on any of this information. SPECIFICALLY, NO WARRANTY OF MERCHANTABILITY, FITNESS FOR A PARTICULAR PURPOSE OR ANY OTHER WARRANTY IS MADE OR TO BE APPLIED WITH RESPECT TO THIS INFORMATION.

To the maximum extent permitted by law, in no event will Autodata Limited or any of its respective officers, directors, employees, representatives or consultants be liable for any damages whatsoever, whether direct or indirect, special, exemplary, punitive or consequential damages (whether such liability arises from a claim based on contract, tort or otherwise), including but not limited to damages resulting from loss of use, loss of profits or any harm or damage to persons or property arising out of or in connection with any download or use of information contained on this website.

© Autodata Limited. All rights reserved. No part of this information may be reproduced or transmitted in any form or by any means, electronic or mechanical, including photocopying, recording or by any information storage or retrieval system, without permission in writing from the copyholder.

AUTODATA and ***Autodata*** are registered trademarks of Autodata Limited and are trademarks of Autodata Limited in foreign jurisdictions.

Model:

Engine code:

Year:

Special tools

- Crankshaft pulley/hub puller – No.103589003300.
- Crankshaft sprocket puller – No.102589053300.
- Flywheel/drive plate locking tool – No.602589004000.
- Injection pump locking tool – No.601589052100.
- Injection pump splined tool – No.601589000800.
- Injection pump sprocket centering tool – No.601589051400.
- Timing chain link installer – No.000589584300.
- Pulley holding tool – No.603589004000.

- Install and tighten tensioner after repairs **3**. Tightening torque: 80 Nm.
- Camshaft sprocket bolt MUST be replaced if length 'X' exceeds 53,6 mm **7**.

General precautions

- Disconnect battery earth lead.
- Remove glow plugs to ease turning engine.
- Turn engine in normal direction of rotation (unless otherwise stated).
- Observe tightening torques.
- If fitted: Mark position of crankshaft position (CKP) sensor before removal.
- Do NOT turn crankshaft via camshaft or other sprockets.
- Do NOT turn crankshaft or camshaft with timing chain removed.
- Check diesel injection pump timing after resetting valve timing – refer to Autodata Diesel Injection Manual.

Valve timing procedures

NOTE: Timing chain can be changed without dismantling engine. Using the tools listed above, the new chain can be linked to the old, passed round the sprockets and then joined.

- Engine at TDC on No.1 cylinder **1**.
- Ensure camshaft timing marks aligned **2**.
- Remove tensioner assembly before carrying out engine repairs **3**.
- During removal/installation of injection pump: Crankshaft position set at 15° ATDC on No.1 cylinder **4**.
- Install injection pump sprocket centering tool before removing bolt **5**. Tool No.601589051400.

NOTE: Injection pump sprocket bolt has LH thread **5.**

- After removal of injection pump, install locking tool **6**. Tool No.601589052100.
- Fill chain tensioner with oil before installation:
 - Submerge tensioner vertically in SAE 10 engine oil with plunger pointing downwards.
 - Compress plunger 7-10 times.
 - After filling, ensure tensioner plunger can be compressed slowly and evenly with considerable effort.

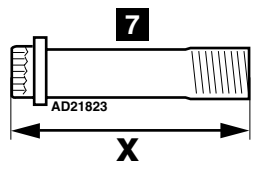
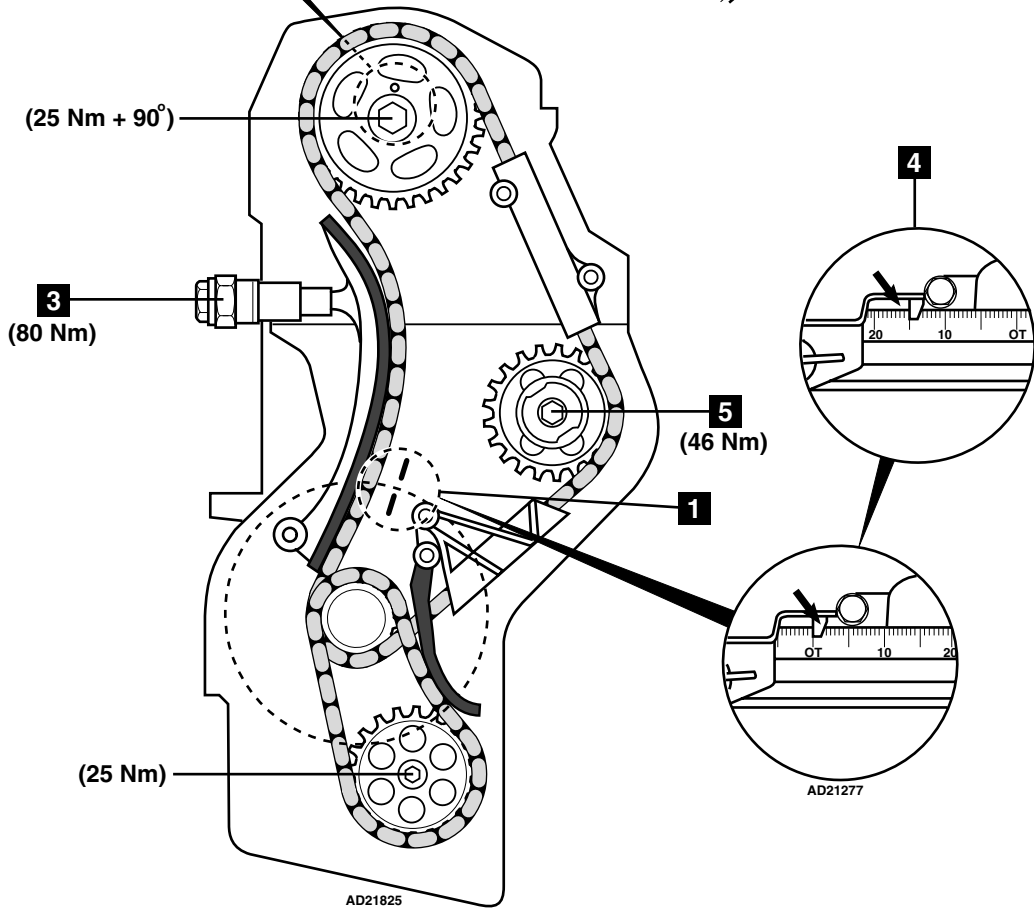
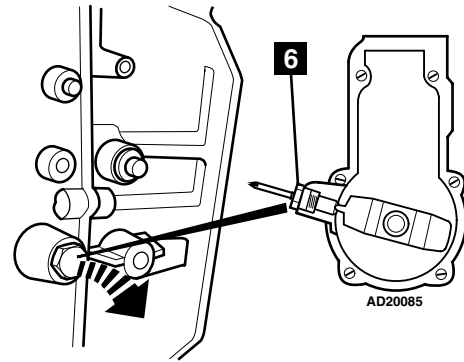
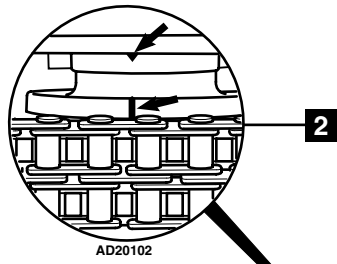

AD11777

